

BEECHMONT AVENUE (S.R. 125)
(R/W VARIES)

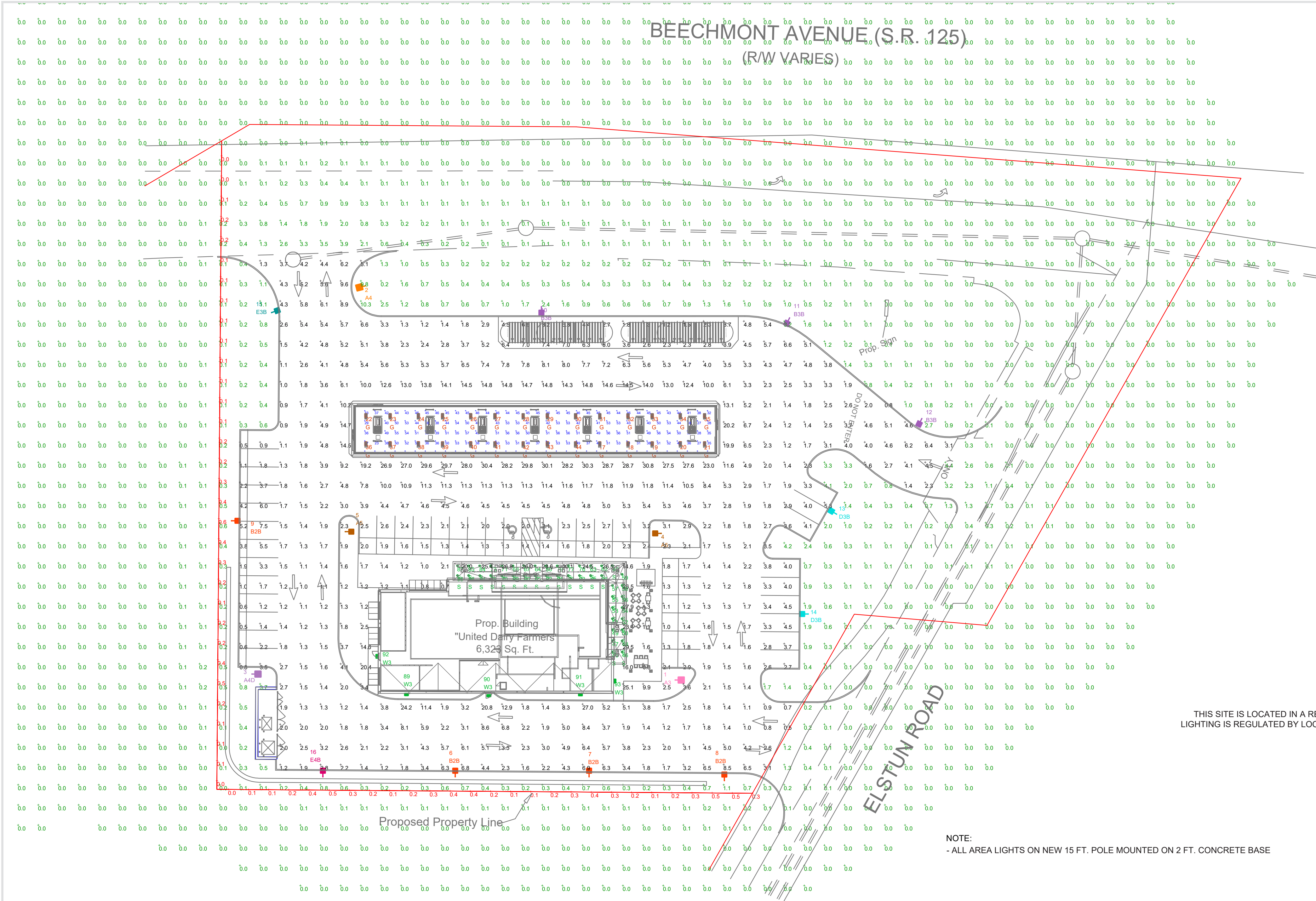

THIS SITE IS LOCATED IN A REGION WHERE LIGHTING IS REGULATED BY LOCAL ORDINANCES

NOTE:
- ALL AREA LIGHTS ON NEW 15 FT. POLE MOUNTED ON 2 FT. CONCRETE BASE

LUMINAIRE LOCATION SUMMARY		
LUM NO.	LABEL	MTG. HT.
1	A3	17
2	A4	17
3	A4D	17
4	A5	17
5	A5	17
6	B2B	17
7	B2B	17
8	B2B	17
9	B2B	17
10	B3B	17
11	B3B	17
12	B3B	17
13	D3B	17
14	D3B	17
15	E3B	17
16	E4B	17
17	G	14.5
18	G	14.5
19	G	14.5
20	G	14.5
21	G	14.5
22	G	14.5
23	G	14.5
24	G	14.5
25	G	14.5
26	G	14.5
27	G	14.5
28	G	14.5
29	G	14.5
30	G	14.5
31	G	14.5
32	G	14.5
33	G	14.5
34	G	14.5
35	G	14.5
36	G	14.5
37	G	14.5
38	G	14.5
39	G	14.5
40	G	14.5
41	G	14.5
42	G	14.5
43	G	14.5
44	G	14.5
45	S	10.6

LUMINAIRE LOCATION SUMMARY		
LUM NO.	LABEL	MTG. HT.
46	S	10.6
47	S	10.6
48	S	10.6
49	S	10.6
50	S	10.6
51	S	10.6
52	S	10.6
53	S	10.6
54	S	10.6
55	S	10.6
56	S	10.6
57	S	10.6
58	S	10.6
59	S	10.6
60	S	10.6
61	S	10.6
62	S	10.6
63	S	10.6
64	S	10.6
65	S	10.6
66	S	10.6
67	S	10.6
68	S	10.6
69	S	10.6
70	S	10.6
71	S	10.6
72	S	10.6
73	S	10.6
74	S	10.6
75	S	10.6
76	S	10.6
77	S	10.6
78	S	10.6
79	S	10.6
80	S	10.6
81	S	10.6
82	S	10.6
83	S	10.6
84	S	10.6
85	S	10.6
86	S	10.6
87	S	10.6
88	S	10.6
89	W3	9
90	W3	9
91	W3	9
92	W3	9
93	W3	9

FOOTCANDLE LEVELS CALCULATED AT GRADE USING INITIAL LUMEN VALUES					
LABEL	AVG	MAX	MIN	AVG/MIN	MAX/MIN
PAVED AREA	5.47	30.8	0.5	10.94	61.60
PROPERTY LINE	0.22	0.6	0.0	N.A.	N.A.
UNDEFINED	0.12	10.3	0.0	N.A.	N.A.
UNER CANOPY	44.72	57	23	1.94	2.48

LUMINAIRE SCHEDULE											
SYMBOL	QTY	LABEL	ARRANGEMENT	LUMENS	LLF	DIMMING LUMEN MULTIPLIER	BUG RATING	WATTS/LUMINAIRE	TOTAL WATTS	MANUFACTURER	CATALOG LOGIC
[Symbol]	1	A3	Single	9843	1.030	0.490	B2-U0-G2	29.91	29.91	Lithonia Lighting	RSX1 LED P2 50K R3 FAO (SW. POS. 3)
[Symbol]	1	A4	Single	16573	1.030	1.000	B2-U0-G3	133.14	133.14	Lithonia Lighting	RSX1 LED P4 50K R4 FAO
[Symbol]	1	A4D	Single	7189	1.030	0.730	B1-U0-G2	33.88	33.88	Lithonia Lighting	RSX1 LED P1 50K R4 FAO (SW. POS. 5)
[Symbol]	2	A5	Single	10104	1.030	0.730	B4-U0-G2	48.17	96.34	Lithonia Lighting	RSX1 LED P2 50K R5 FAO (SW. POS. 5)
[Symbol]	4	B2B	Single	5384	1.030	1.000	B1-U0-G1	51.34	205.36	Lithonia Lighting	RSX1 LED P1 50K R2 HS FAO
[Symbol]	3	B3B	Single	9841	1.030	1.000	B1-U0-G2	109.44	328.32	Lithonia Lighting	RSX1 LED P3 50K R3 HS FAO
[Symbol]	2	D3B	Single	6908	1.030	1.000	B1-U0-G2	72.95	145.9	Lithonia Lighting	RSX1 LED P2 50K R3 HS FAO
[Symbol]	1	E3B	Single	4980	1.030	1.000	B1-U0-G2	51.34	51.34	Lithonia Lighting	RSX1 LED P1 50K R3 HS FAO
[Symbol]	1	E4B	SINGLE	4724	1.030	0.730	B1-U0-G1	33.88	33.88	Lithonia Lighting	RSX1 LED P1 50K R4 HS FAO (SW. POS. 5)
[Symbol]	28	G	SINGLE	13228	1.000	1.000	B3-U0-G1	96.2394	2694.703	Lithonia Lighting	RCNY LED SYMC ALO2 Setting 5 80CRI 50K MVOLT
[Symbol]	44	S	SINGLE	1069	1.000	1.000	B1-U0-G0	607.2	26716.8	WILLIAMS INDOOR	6DR-TL-L15-940-DIM-UNV-OW-OF-CS-WET-CC
[Symbol]	5	W3	Single	6614	1.000	1.000	B1-U0-G1	51.2609	256.304	Lithonia Lighting	ARC2 LED P5 40K MVOLT XX XXXX

REV.	BY	DATE	DESCRIPTION
R1	JSG	10/25/24	REWORK LIGHTING PER UPDATED SITE PLAN. AREA, WALL & CANOPY LIGHTS WERE CREE

DISCLAIMER
ANY SITE PLAN(S), FLOOR PLAN(S), RENDERING(S), LIGHTING LAYOUT(S) AND PHOTOMETRIC PLAN(S) INCLUDING BUT NOT LIMITED TO ANY PROJECT(S) CREATED/PRODUCED BY RED LEONARD ASSOCIATES INC., ARE ONLY INTENDED FOR ILLUSTRATION AND QUOTING PURPOSES ONLY. RED LEONARD ASSOCIATES HAS THE RIGHT TO USE THIRD PARTY LASERS, SCANNERS, AND CAMERAS BUT ACTUAL PROJECT CONDITIONS, DIMENSIONS, AND ACCURACY OF MEASUREMENTS MAY DIFFER FROM THESE OR ANY PARAMETERS. RED LEONARD ASSOCIATES INC. ASSUMES NO LIABILITY FOR WHAT IS CREATED/PRODUCED IN THESE RENDERINGS. THIS INCLUDES BUT IS NOT LIMITED TO THE USE OF, INSTALLATION OF AND/OR INTEGRITY OF EXISTING BUILDING(S), SURROUNDING AREA FOR PROJECT(S) SUCH AS EXISTING POLES, ANCHOR BOLTS, BASES, ARCHITECTURAL AND SIGNAGE STRUCTURE(S), LANDSCAPING PLAN(S), LIGHTING PLAN(S), FIXTURE SELECTION(S) AND PLACEMENT, MATERIAL(S), COLOR ACCURACY, TEXTURE(S), AND ANYTHING ATTRIBUTED TO PHOTO REALISM THAT IS CREATED. FURTHERMORE, RED LEONARD ASSOCIATES INC. DOES NOT ASSUME LIABILITY WHATSOEVER FOR ANY PURCHASES MADE BY CLIENT BEFORE, DURING, OR AT THE CONCLUSION OF THE PUBLISHED WORK. THE CUSTOMER, ITS RELATIVE AFFILIATES, AS WELL AS ANY OTHER PERSON(S) IN VIEWING OF THIS PROJECT IS RESPONSIBLE FOR VERIFYING COMPLIANCE WITH ANY BUT NOT LIMITED TO ALL CODES, PERMITS, RESTRICTIONS, INSTRUCTIONS, PURCHASES, AND INSTALLATIONS OF OBJECTS VIEWED WITHIN THIS DOCUMENT(S) OR PROJECT(S). SYMBOLS ARE NOT DRAWN TO SCALE. SIZE IS FOR CLARITY PURPOSES ONLY. SIZES AND DIMENSIONS ARE APPROXIMATE. ACTUAL MEASUREMENTS MAY VARY. DRAWINGS ARE NOT INTENDED FOR ENGINEERING OR CONSTRUCTION USE. THIS DOCUMENT, ANY RED LEONARD DRAWING(S) OR PROJECT(S) IS NOT TO BE USED AND/OR INTENDED FOR ENGINEERING OR CONSTRUCTION PURPOSES, BUT FOR ILLUSTRATIVE PURPOSES ONLY. ANY LOCATIONS OF EMERGENCY LIGHTING SHOWN WERE PROVIDED BY OTHERS. RED LEONARD ASSOCIATES IS NOT RESPONSIBLE FOR INSUFFICIENT LIGHTING DURING AN EMERGENCY EVENT. ANY USE OF THIS DOCUMENTATION AND/OR OTHER ARTICLES PRODUCED BY RED LEONARD WITHOUT WRITTEN AUTHORIZATION FROM JAVINE J. LEONARD IS STRICTLY PROHIBITED.

SCALE: 1" = 30'
LAYOUT BY: JSG
DWG SIZE: D
DATE: 3/10/23

PROJECT NAME: UDF
BEECHMONT & ELSTUN
DRAWING NUMBER: RL-8665-S1-R1



QTY	LABEL	DESCRIPTION
1	A3	RSX1 LED P2 50K R3 FAO (SW. POS. 3)
1	A4	RSX1 LED P4 50K R4 FAO
1	A4D	RSX1 LED P1 50K R4 FAO (SW. POS. 5)
2	A5	RSX1 LED P2 50K R5 FAO (SW. POS. 5)
4	B2B	RSX1 LED P1 50K R2 HS FAO
3	B3B	RSX1 LED P3 50K R3 HS FAO
2	D3B	RSX1 LED P2 50K R3 HS FAO
1	E3B	RSX1 LED P1 50K R3 HS FAO
1	E4B	RSX1 LED P1 50K R4 HS FAO (SW. POS. 5)

ADDITIONAL FIXTURE INFO



RSX2 LED Area Luminaire

Specifications

EPA (EW07): 0.69 ft² (0.06 m²)

Length: 29.3" (74.4 cm) (SPA mount)

Width: 13.4" (34.0 cm)

Height: 3.0" (7.6 cm) Main Body
7.2" (18.3 cm) Arms

Weight (SPA mount): 30.0 lbs (13.6 kg)

Introduction

The new RSX LED Area family delivers maximum value by providing significant energy savings, long life and outstanding photometric performance at an affordable price. The RSX2 delivers 11,000 to 31,000 lumens allowing it to replace ZSW to 100W HID luminaires.

The RSX features an integral universal mounting mechanism that allows the luminaire to be mounted on most existing drill hole patterns. This "no-drill" solution provides significant labor savings. An easy-access door on the bottom of mounting arm allows for wiring without opening the electrical compartment. A mast arm adaptor, adjustable integral alignter and other mounting configurations are available.

Items marked with a **Design Select** icon qualify for the Design Select program and ship in 15 days after. To learn more about Design Select, visit www.redleopard.com/designselect. See ordering page for details.

Series	Performance Package	Color Temperature	Beam/Distribution	Voltage	Mounting
RSX2 LED	P1	30K	300K	82	Spot 2-1/8"
	P2	40K	400K	82	Spot 2-1/8"
	P3	50K	500K	82	Spot 2-1/8"
	P4	60K	600K	82	Spot 2-1/8"
	P5	70K	700K	82	Spot 2-1/8"
	P6	80K	800K	82	Spot 2-1/8"
RSX2 LED	P1	30K	300K	82	Spot 2-1/8"
	P2	40K	400K	82	Spot 2-1/8"
	P3	50K	500K	82	Spot 2-1/8"
	P4	60K	600K	82	Spot 2-1/8"
	P5	70K	700K	82	Spot 2-1/8"
	P6	80K	800K	82	Spot 2-1/8"

One Lithonia Way • Corning, Georgia 30012 • Phone: 1-800-765-SERV (7378) • www.redleopard.com

QTY	LABEL	DESCRIPTION
28	G	RCNY LED SYMC AL02 SETTING 5 80CRI 50K MVOLT

ADDITIONAL FIXTURE INFO



RCNY LED Recessed LED Canopy/Ceiling Luminaire

Specifications

Width: RCNY LED 11.5"

Height: 5.9"

Length: 11.5"

Weight: 14lbs

Introduction

The Velarium RCNY LED recessed luminaire is designed to provide exceptional energy savings and versatility in one fixture. With a compact design the RCNY provides superior illumination while blending into the canopy space seamlessly. The RCNY is unique in that as a recessed canopy it can be installed in both 12" and 16" canopy decks. Features such as Adjustable Lumen Output and forward throw distribution option make the RCNY one of the most versatile gas station canopies in the market. With up to 159 LPW the RCNY LED delivers up to 80% in energy savings when replacing metal halide luminaires. With over 100,000 hour life expectancy (12+ years of 24/7 continuous operation), the RCNY LED luminaire provides significant maintenance savings over traditional luminaires.

Series	Performance Package	Color Temperature	CR	Life
RCNY LED	A01	5000-10000 Lumens	90+	50K
	A02	5000-10000 Lumens	90+	50K

Voltage	Size	Trim Finish	System
W01	150-277V	82	11.5" Square Box
W02	120-277V	82	11.5" Square Box

One Lithonia Way • Corning, Georgia 30012 • Phone: 1-800-765-SERV (7378) • www.redleopard.com

Ordering Information

Accessories

External Shields

House Side Shield, External Glare Shield, External 360 Full Visor

Handhold Orientation

RSX Pole Drilling

RSX Standard Arm & Adjustable Arm

Performance Data

Symmetric Clear Lens, 70CRI

Performance Package	Lenses	System Watts	120V	208V	277V	347V
A02	1	26	1359	136	1760	1801
A02	2	40	8231	137	8462	148
A02	3	41	8493	145	8450	154
A02	4	79	11293	142	11266	154
A02	5	76	10489	142	10438	154
A02	6	114	15271	142	14981	154
A02	7	112	15256	142	15056	154
A02	8	141	16713	133	20312	144
A01	1	14	1700	136	1890	136
A01	2	25	3380	134	3332	134
A01	3	31	4297	139	4260	139
A01	4	39	5266	144	5261	144
A01	5	47	6261	146	6227	146
A01	6	51	7243	146	6260	146
A01	7	60	8327	146	8403	146
A01	8	66	9323	151	9320	151

One Lithonia Way • Corning, Georgia 30012 • Phone: 1-800-765-SERV (7378) • www.redleopard.com

QTY	LABEL	DESCRIPTION
5	W3	ARC2 LED P5 40K MVOLT XX XXXX

ADDITIONAL FIXTURE INFO



ARC2 LED Architectural Wall Luminaire

Specifications

Depth (D1): 9.25"

Depth (D2): 7.5"

Height: 5"

Width: 14"

Weight (without options): 11 lbs

Introduction

The Lithonia Lighting ARC LED wall-mounted luminaires provide both architectural styling and visually comfortable illumination while providing the high energy savings and low initial costs for quick financial payback. ARC2 delivers up to 6,500 lumens with a soft, non-pixelated light source, creating a visually comfortable environment. It offers integrated emergency battery backup options, including an 8W cold temperature option, making it suitable for pedestrian scale applications in any environment.

ARC LED Family Overview

Luminaire	Standard DIM, °C	Cold DIM, -10°C	P1	P2	P3	P4	P5
ARC1 LED	4W	--	1,500	2,000	1,000	--	--
ARC2 LED	4W	8W	1,500	3,000	1,000	4,000	6,500

Ordering Information

Series	Package	Color Temperature	Width	Options	Finish
ARC2 LED	P1	1,500 Lumens	30K 300K	W01	E088
	P2	2,000 Lumens	40K 400K	W02	E088
	P3	1,000 Lumens	50K 500K	W03	E088
	P4	4,000 Lumens	60K 600K	W04	E088
	P5	6,500 Lumens	70K 700K	W05	E088
	P5	6,500 Lumens	80K 800K	W06	E088

Accessories

Series	Performance Package	Color Temperature	Beam/Distribution	Voltage	Options	Finish
ARC2 LED	P1	1,500 Lumens	30K 300K	W01	E088	Dark Bronze
	P2	2,000 Lumens	40K 400K	W02	E088	Black
	P3	1,000 Lumens	50K 500K	W03	E088	Neutral Aluminum
	P4	4,000 Lumens	60K 600K	W04	E088	White
	P5	6,500 Lumens	70K 700K	W05	E088	Satin Bronze
	P5	6,500 Lumens	80K 800K	W06	E088	Neutral Aluminum

Performance Data

Lumen Output

Use these factors to determine lumen output for average ambient temperature based on configuration or beam angle.

Performance Package	System Watts	120V	208V	277V	347V
P1	17W	1,500	142	0	0
P2	16W	2,200	140	0	0
P3	24W	3,206	135	0	0
P4	30W	1,303	128	1	0
P5	37W	6,260	122	1	0

Electrical Load

Performance Package	System Watts	120V	208V	277V	347V
P1	17W	0.800	0.655	0.661	0.645
P2	16W	0.741	0.681	0.672	0.664
P3	24W	0.262	0.117	0.163	0.091
P4	30W	0.280	0.162	0.144	0.128
P5	37W	0.471	0.232	0.238	0.232

Projected LED Lumen Maintenance

Ambient	Lumen Multiplier
0°C	1.04
10°C	1.03
20°C	1.01
25°C	1.00
30°C	0.99
40°C	0.97

Photometric Diagrams

Use these factors to determine lumen output for average ambient temperature based on configuration or beam angle.

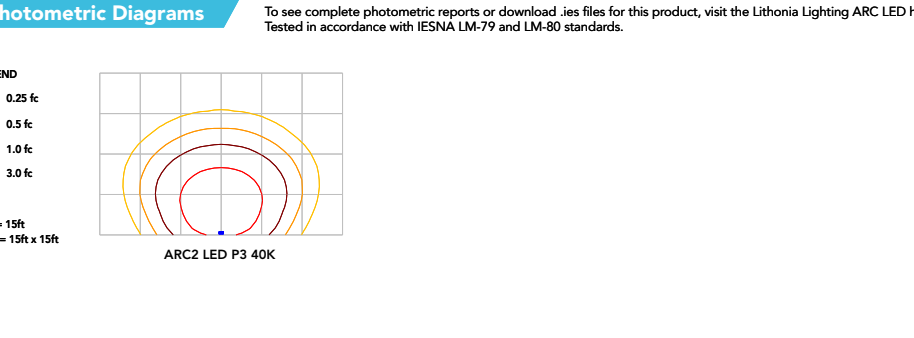

One Lithonia Way • Corning, Georgia 30012 • Phone: 1-800-765-SERV (7378) • www.redleopard.com

